

MK1 n.2 PEZZI

VISTA SUPERIORE A-A

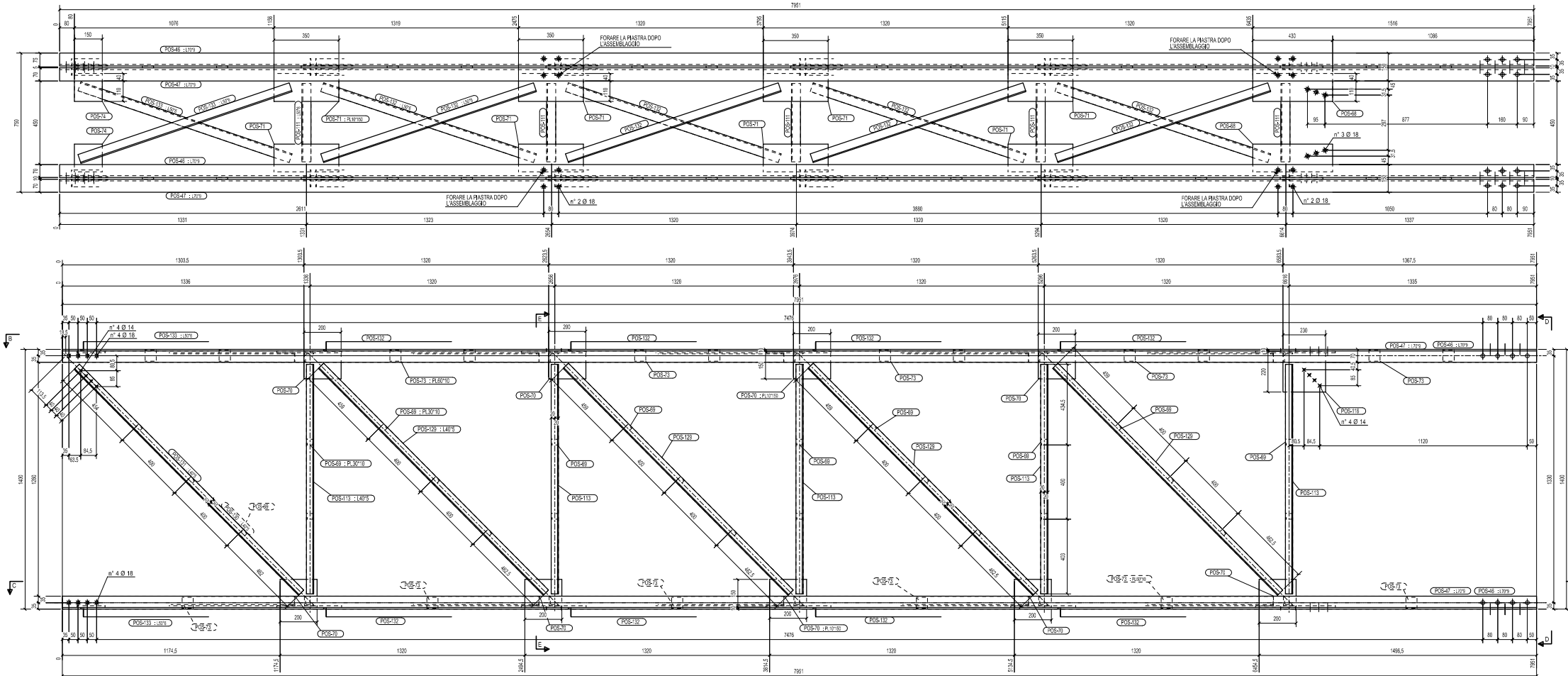

SEZIONE INFERIORE C-C

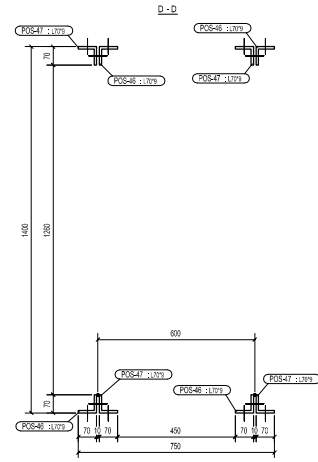
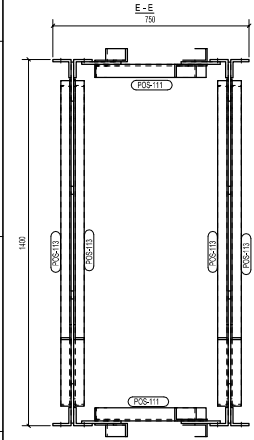
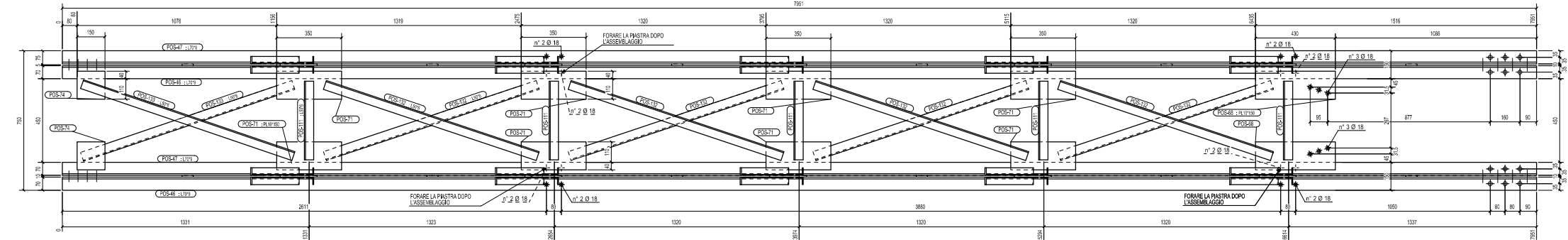

LISTA MATERIALI PER UN ASSEMBLAGGIO DI MARCA MK1

Marca	Dimensioni	Materiale	N°	Lunghezza	peso (kg)	Richiedi
POS-46	L70*9	S275JR	4	7951	2,2	74,3
POS-47	L70*9	S275JR	4	7951	2,2	74,3
POS-132	L50*6	S275JR	16	1210	0,2	5,4
POS-133	L50*6	S275JR	4	1203	0,2	5,4
POS-68	PL10*150	S275JR	4	430	0,1	5,1
POS-129	L40*5	S275JR	16	1721	0,3	5,1
POS-130	L40*5	S275JR	2	1716	0,3	5,1
POS-131	L40*5	S275JR	2	1716	0,3	5,1
POS-71	PL10*150	S275JR	16	350	0,1	4,1
POS-116	PL10*220	S275JR	2	230	0,1	4,0
POS-113	L40*5	S275JR	20	1337	0,2	3,7
POS-70	PL10*150	S275JR	18	200	0,1	2,4
POS-111	L50*6	S275JR	10	423	0,1	1,9
POS-74	PL10*150	S275JR	4	150	0,1	1,8
POS-73	PL60*10	S275JR	36	59	0,0	0,3
POS-69	PL30*10	S275JR	50	30	0,0	0,1
Totale DISEGNO					73,0	2108,3